

#060020908

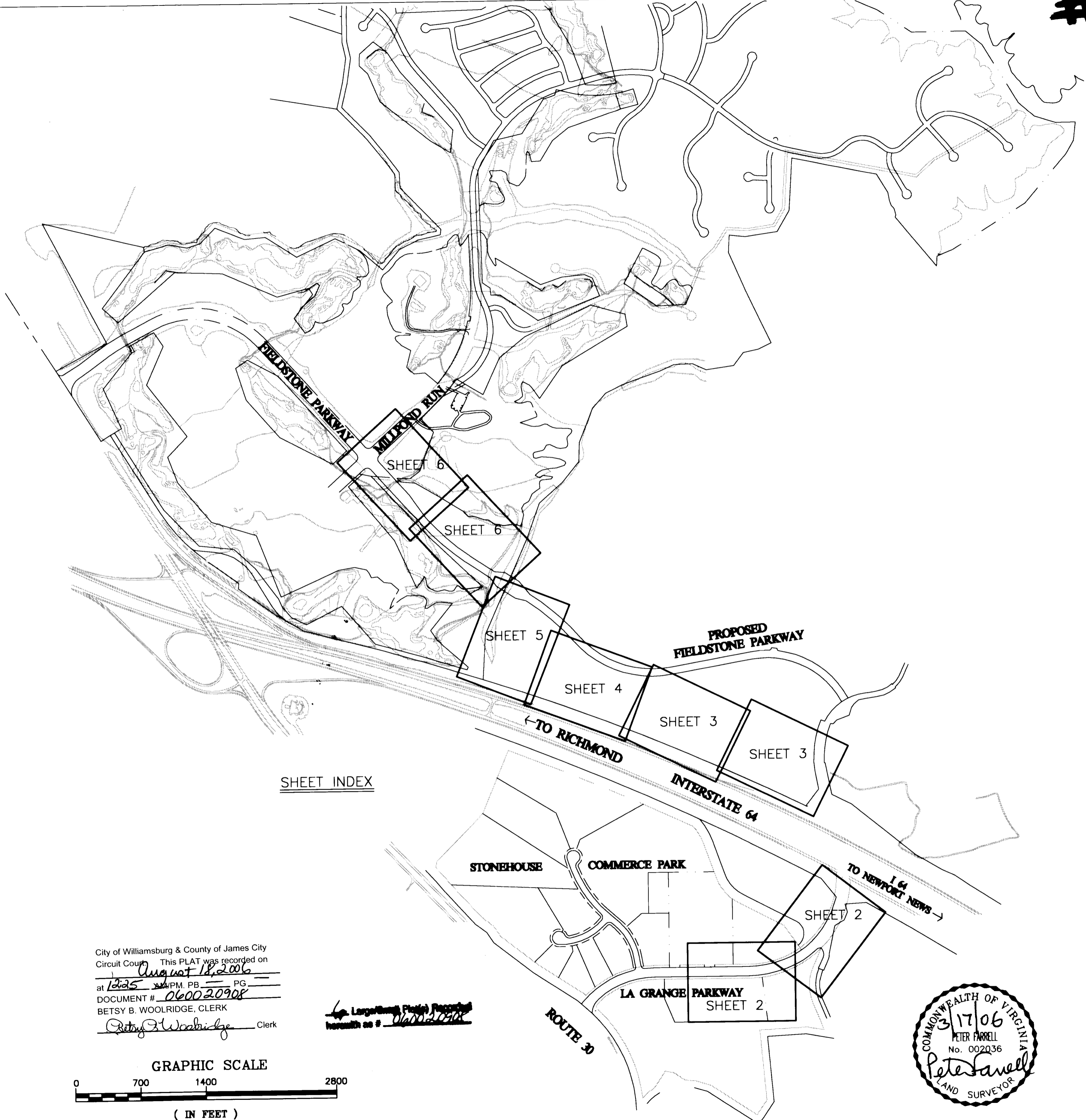

LIST OF OWNERS CONVEYING EASEMENT

SHEET#2	COMMERCE PARK AT STONEHOUSE, L.L.C.
SHEET#3	STONEHOUSE GLEN, L.L.C.
SHEET#4	STONEHOUSE GLEN, L.L.C.
SHEET#5	STONEHOUSE GLEN, L.L.C.
POINT 'A' TO 'B'	FIELDSTONE INVESTMENT, L.L.C.
POINT 'B' TO 'C'	FIELDSTONE INVESTMENT, L.L.C.
SHEET#6	FIELDSTONE INVESTMENT, L.L.C.

NOTE:
 THE TERMS OF THE JCSA UTILITY EASEMENT SHOWN ON THIS PLAT SHALL BE IN ACCORDANCE WITH THE DEED OF EASEMENT, DATED APRIL 6, 2006 BY AND BETWEEN FIELDSTONE INVESTMENT, LLC, STONEHOUSE GLEN, LLC, COMMERCE PARK AT STONEHOUSE, LLC AND THE JAMES CITY SERVICE AUTHORITY RECORDED SIMULTANEOUSLY WITH THIS PLAT.

CURVE TABLE						
CURVE	LENGTH	RADIUS	TANGENT	CHORD	CHORD BEARING	DELTA
C1	1007.20'	24811.33'	503.67'	1007.13'	N64°29'12"W	2°19'33"
C2	1102.13'	24811.33'	551.15'	1102.03'	N66°55'20"W	2°32'42"
C3	1076.22'	24811.33'	538.19'	1076.13'	N69°26'15"W	2°29'07"
C4	309.10'	24811.33'	154.55'	309.10'	N71°02'13"W	0°42'50"
C5	279.92'	966.00'	140.95'	278.94'	N80°10'45"E	16°36'10"

PLAT SHOWING
 UTILITY EASEMENT
 TO BE DEDICATED TO
 JAMES CITY SERVICE
 AUTHORITY
 STONEHOUSE DISTRICT
 JAMES CITY COUNTY, VIRGINIA
 DATE: 3/17/06 SCALE 1"=700'
 SHEET 1 OF 6

City of Williamsburg & County of James City
 Circuit Court This PLAT was recorded on
 August 14, 2006
 at 10:25 AM, P.M. PG. _____
 DOCUMENT # 060020908
 BETSY B. WOOLRIDGE, CLERK
 Betsy B. Woolridge Clerk

Large-Scale Plats Recorded
 hereunder as # 060020908

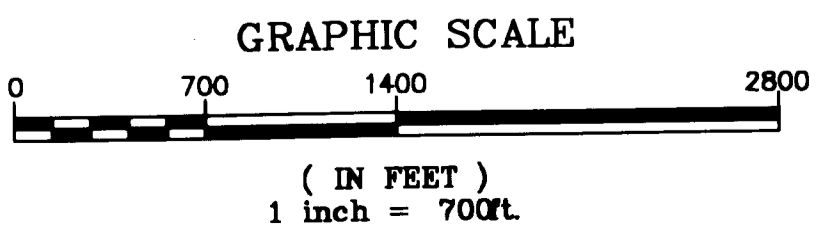
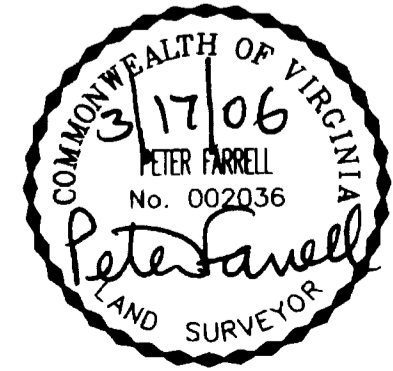

LANDMARK
DESIGN GROUP
 Engineers • Planners • Surveyors
 Landscape Architects • Environmental Consultants

4029 Ironbound Road
 Suite 100
 Williamsburg, VA 23188
 Tel. (757) 253-2975
 Fax (757) 229-0049
 Email: lmdg@landmarkdg.com