

#060017849

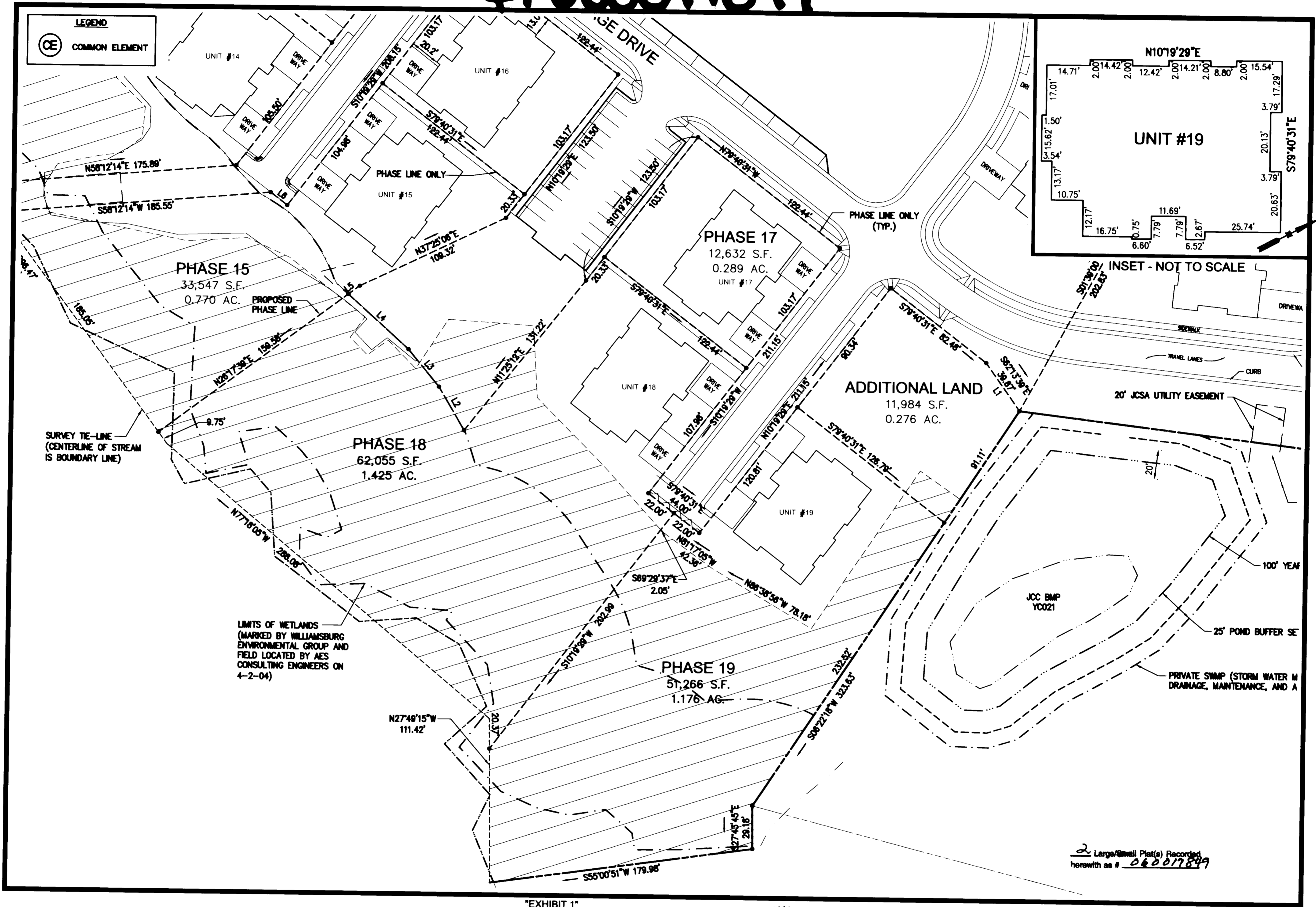

2 Large/Small Plat(s) Recorded herewith as # 060017849



5248 Olde Towne Road, Suite 1
Williamsburg, Virginia 23188
(757) 253-0040
Fax (757) 220-8994

CONSULTING ENGINEERS
WILLIAMSBURG • RICHMOND • GLOUCESTER •

"EXHIBIT 1"
PLAT OF CONDOMINIUM
WILLIAMSBURG VILLAGE AT NORGE CONDOMINIUM
PHASE 19, UNIT #19
STONEHOUSE DISTRICT COUNTY OF JAMES CITY VIRGINIA

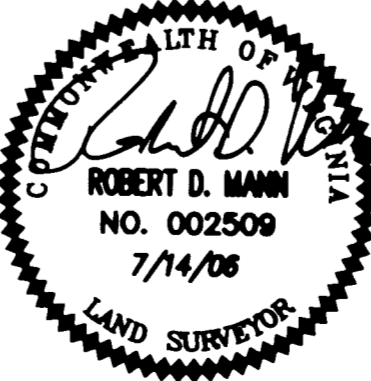

City of Williamsburg & County of James City Circuit Court: This PLAT was recorded on				
at 1:26 PM July 2006				
DOCUMENT # 060017849				
BETSY B. WOOLRIDGE, CLERK				
Clerk				
No.	DATE	REVISION / COMMENT / NOTE	REVIEWED BY	REVIEWED BY

Designed VMB/JAG	Drawn AWT/ecw
Scale 1"=40'	Date 7/14/06
Project No. 9286-2	
Drawing No. 2 of 2	

S:\Jobs\9286\02-Norge Condo Plats.dwg\Plats\Record\Phase 19\928602Condo Sh 002 PHASE 19.dwg, 7/18/2006 9:19:42 AM, AES Mylar Plotter (williamsburg).pc3