

#050029103

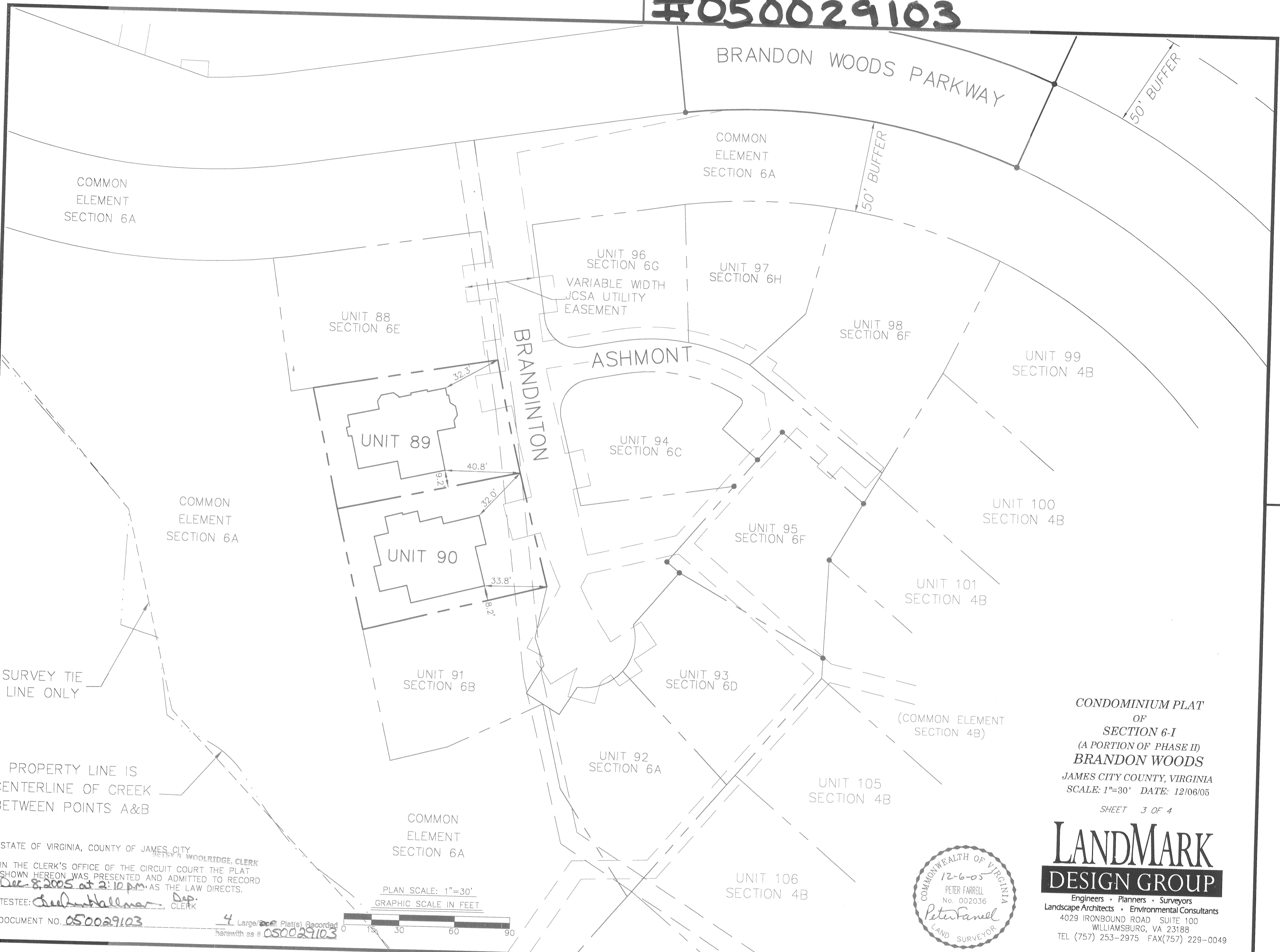

CONDOMINIUM PLAT
OF
SECTION 6-I
(A PORTION OF PHASE II)
BRANDON WOODS
JAMES CITY COUNTY, VIRGINIA
SCALE: 1"=30' DATE: 12/06/05
SHEET 3 OF 4

LANDMARK
DESIGN GROUP

Engineers • Planners • Surveyors
Landscape Architects • Environmental Consultants
4029 IRONBOUND ROAD SUITE 100
WILLIAMSBURG, VA 23188
TEL (757) 253-2975 FAX(757) 229-0049

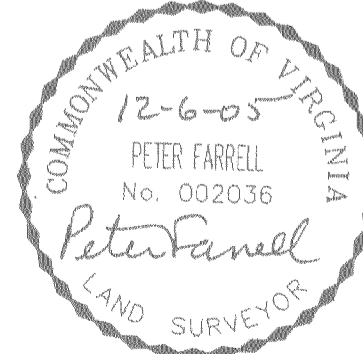

STATE OF VIRGINIA, COUNTY OF JAMES CITY
JESSY S. WOOLRIDGE, CLERK
IN THE CLERK'S OFFICE OF THE CIRCUIT COURT THE PLAT
SHOWN HEREON WAS PRESENTED AND ADMITTED TO RECORD
Dec. 8, 2005 at 2:10 p.m. AS THE LAW DIRECTS.
TESTEE: *[Signature]* Dep. CLERK

PLAN SCALE: 1"=30'
GRAPHIC SCALE IN FEET



DOCUMENT NO. 050029103
4 Large Scale Plat(s) Recorded
Herewith as # 050029103

DRAWN BY: PF
CHKD BY: AST
PROJ. NO.: 1980074-000.62
DWG. NO.: 16726W