

#040032114

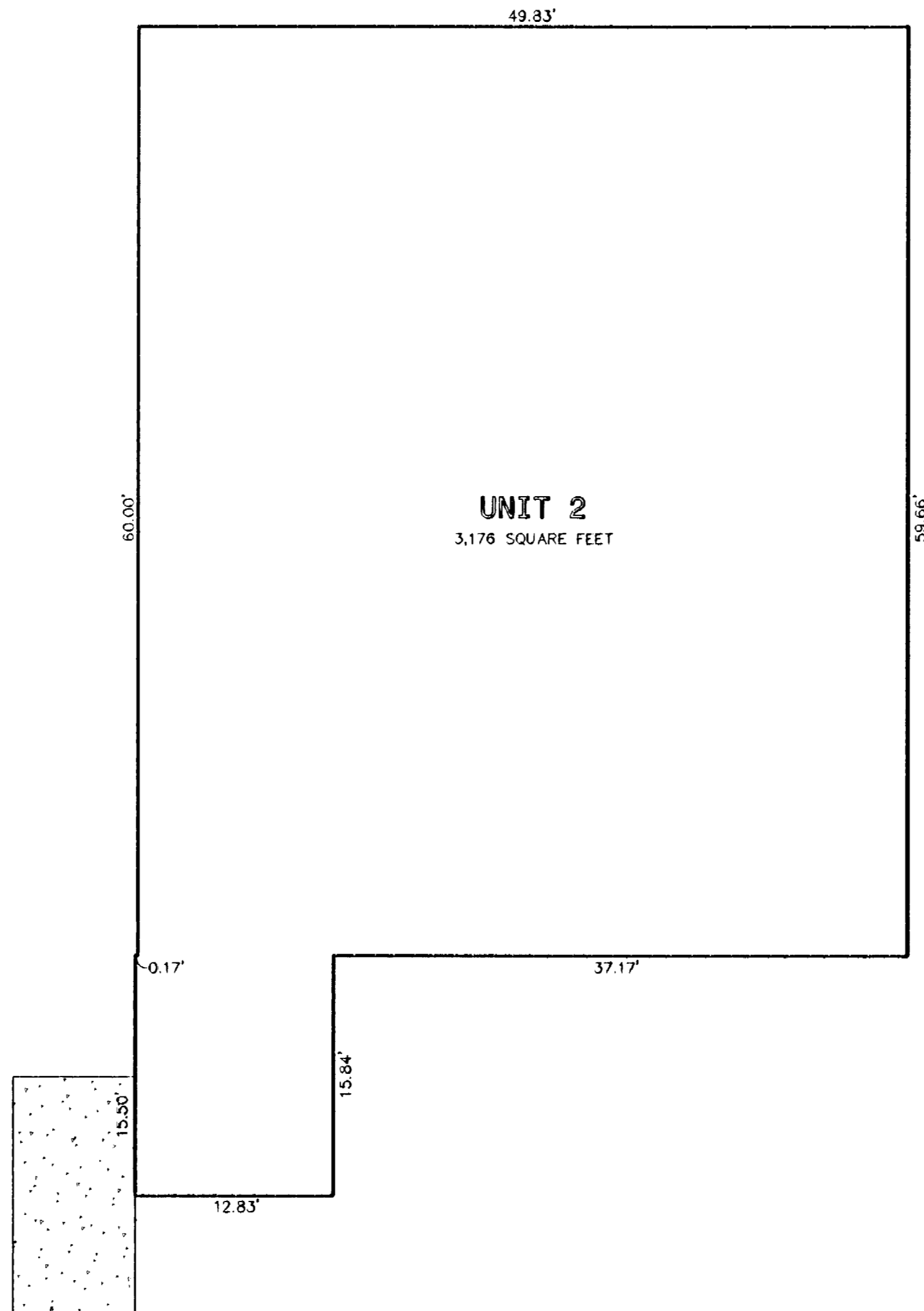

QUARTERLAND COMMONS X
 351 McLAWS CIRCLE , A CONDOMINIUM
 ROBERTS DISTRICT , JAMES CITY COUNTY , VIRGINIA

QUARTERLAND COMMONS X

SCALE : 1" = 8'-0" DECEMBER 20, 2004
 SHEET NO. 1 OF 1

LEGEND

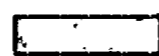
 CONCRETE PORCH L.C.E.
 L.C.E. DENOTES LIMITED COMMON ELEMENT

DAVID F. BUGIN, ARCHITECTS
 ARCHITECTURE AND PLANNING
 POST OFFICE BOX 1804
 NEWPORT NEWS
 VIRGINIA
 23601

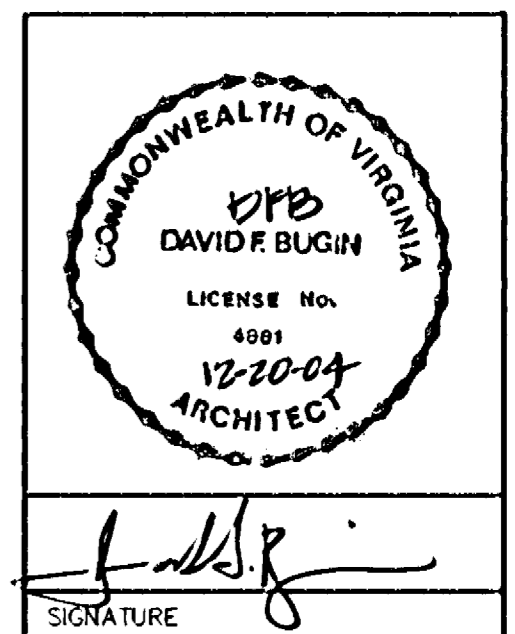

I CERTIFY THAT THIS PLAT IS ACCURATE AND COMPLIES WITH THE PROVISIONS OF SECTION 55-79.58(b) OF THE CODE OF VIRGINIA 1950 AS AMENDED AND THAT UNITS 1 AND 3 AS DEPICTED HEREON HAVE BEEN SUBSTANTIALLY COMPLETED.

City of Williamsburg & County of James City
 Circuit Court: This PLAT was recorded on
 at 10:51 AM on 12-27-2004 PG
 DOCUMENT # 040032114
 BETSY B. WOOLRIDGE, CLERK
Betsy B. Woolridge Clerk