

#040012081

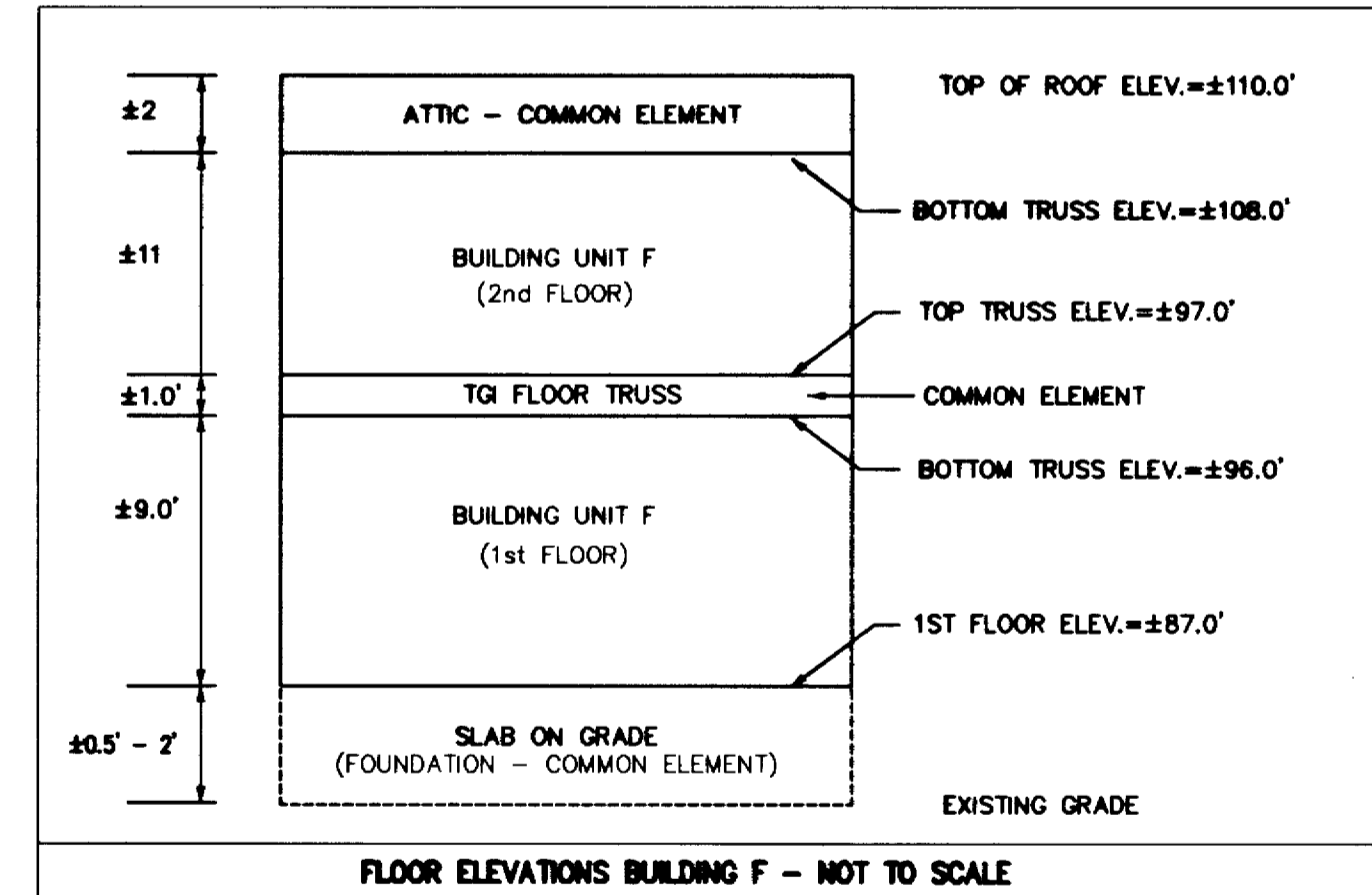
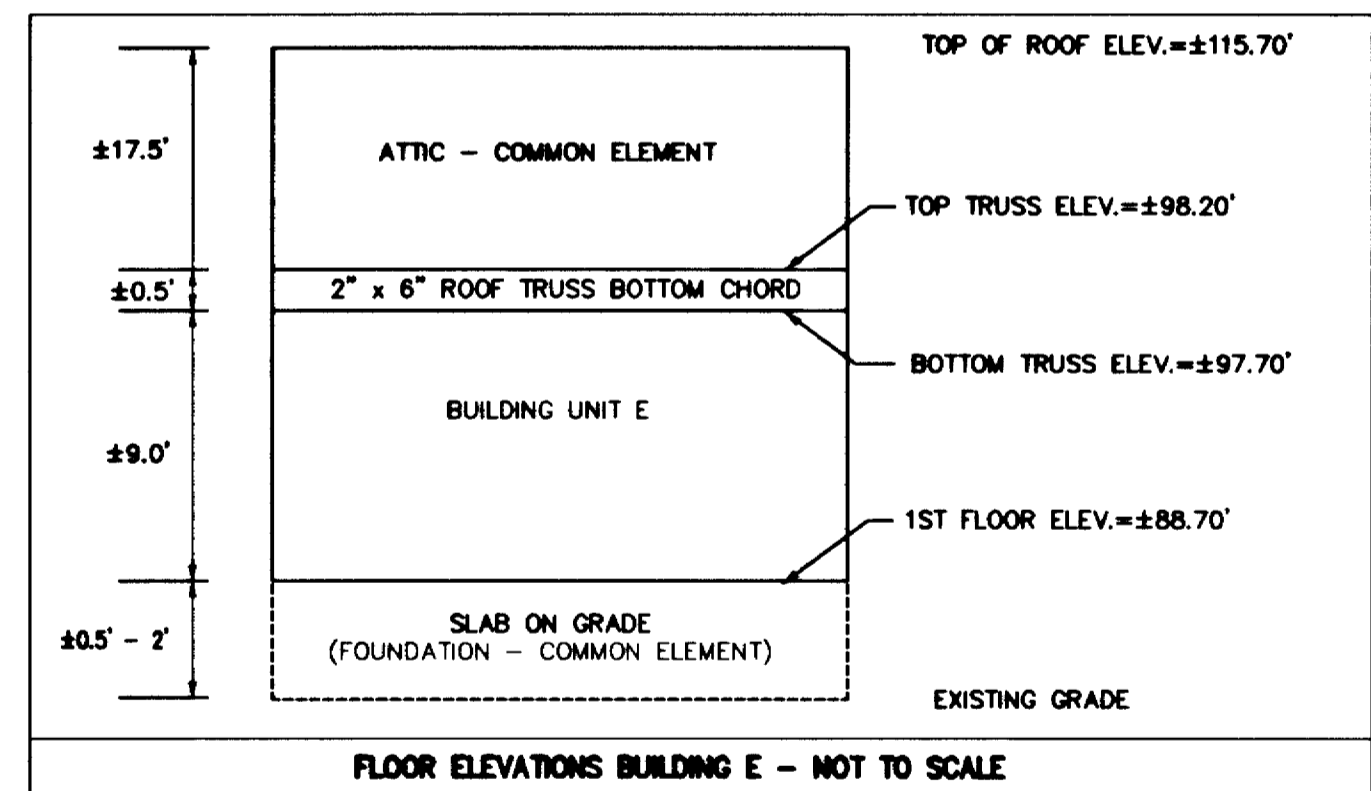
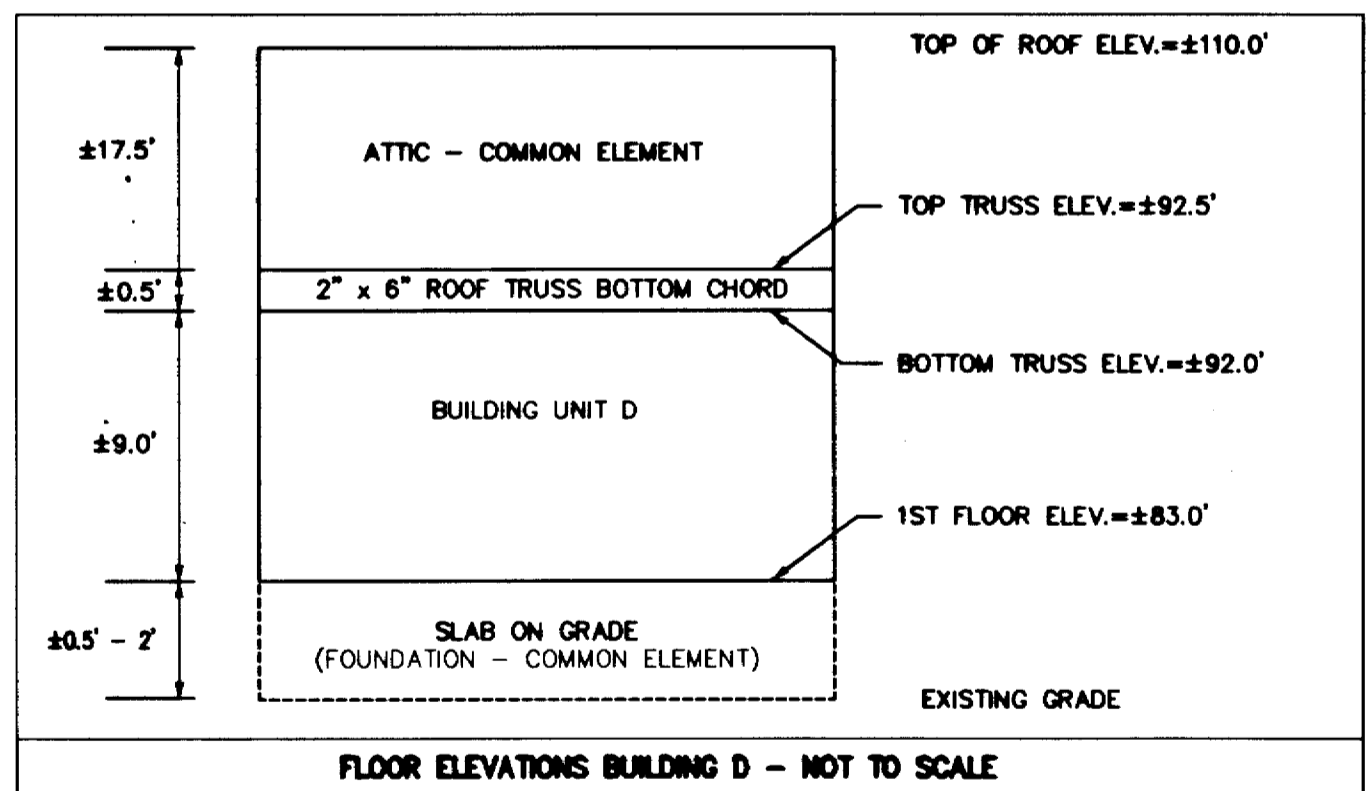
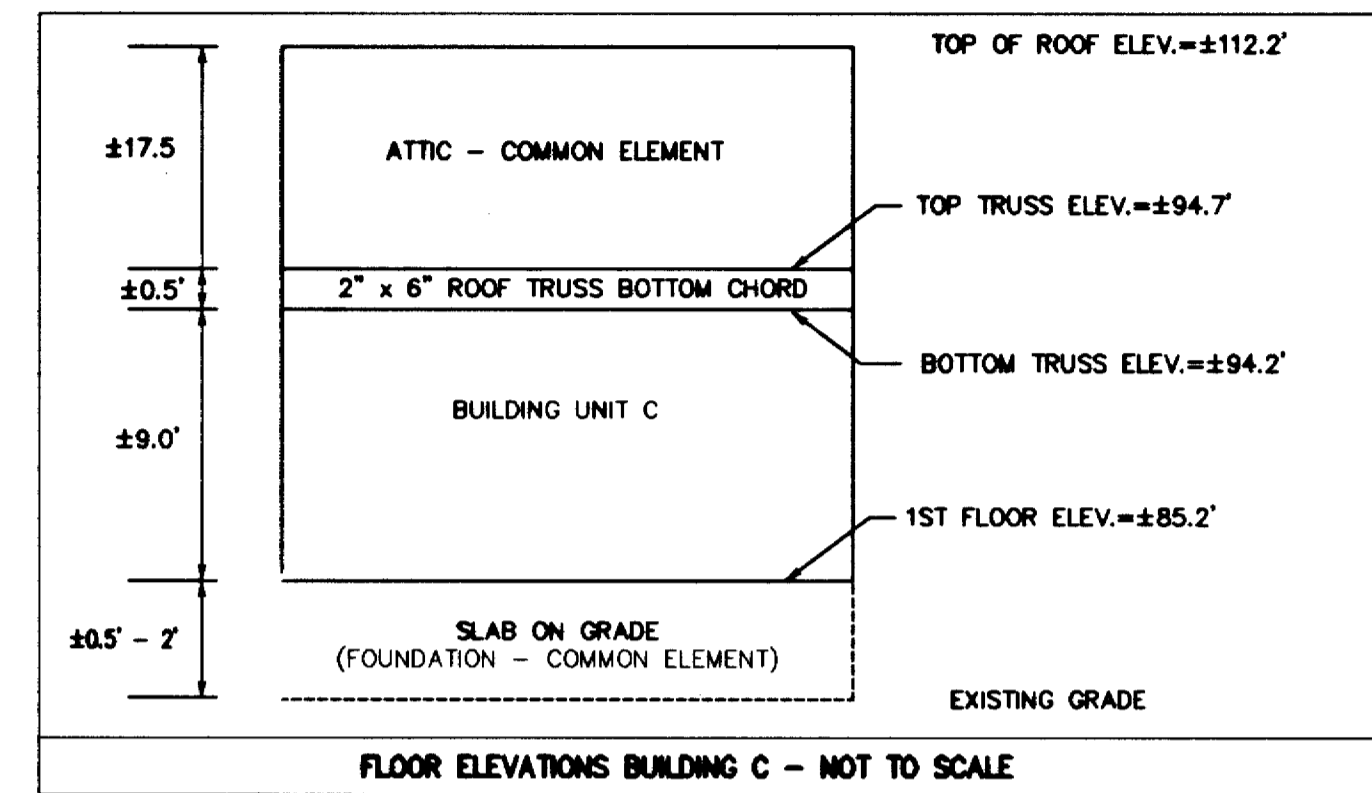
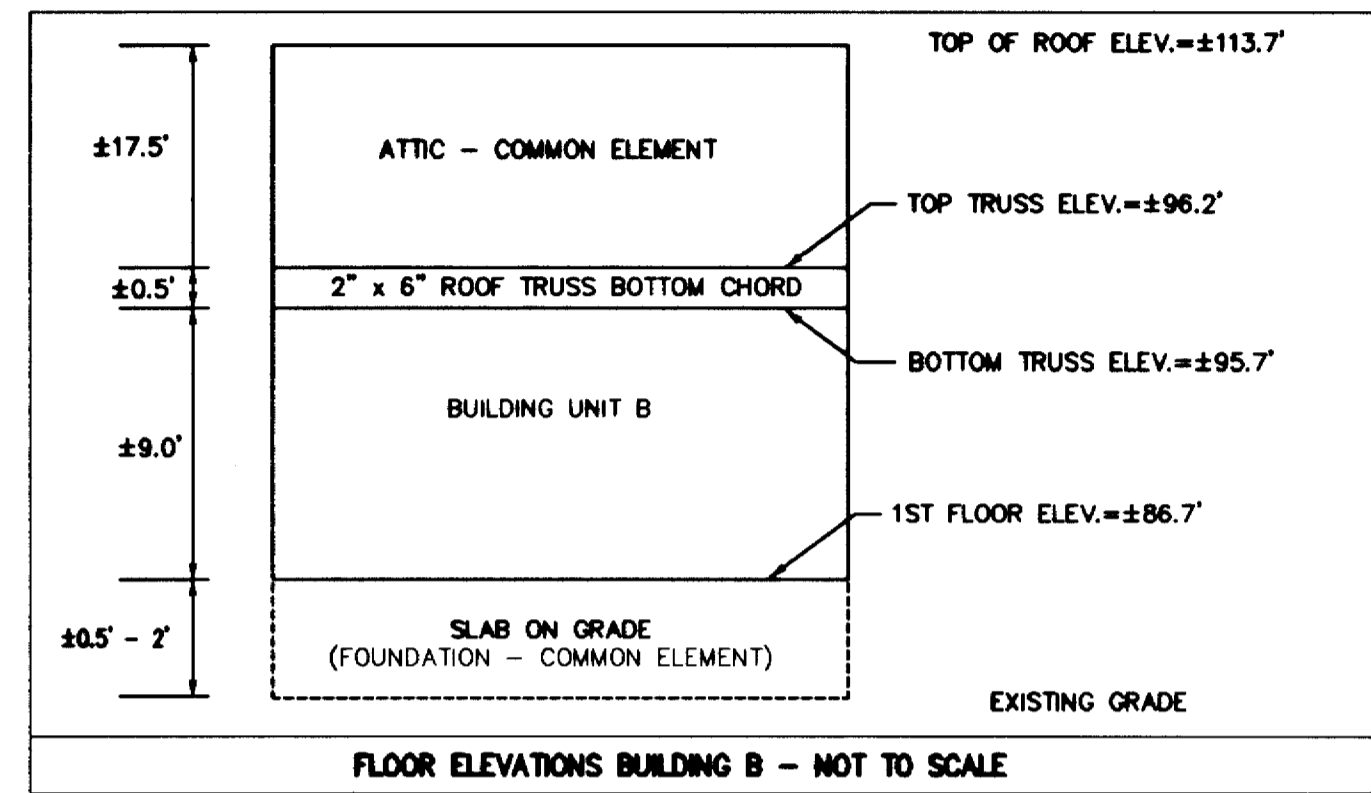
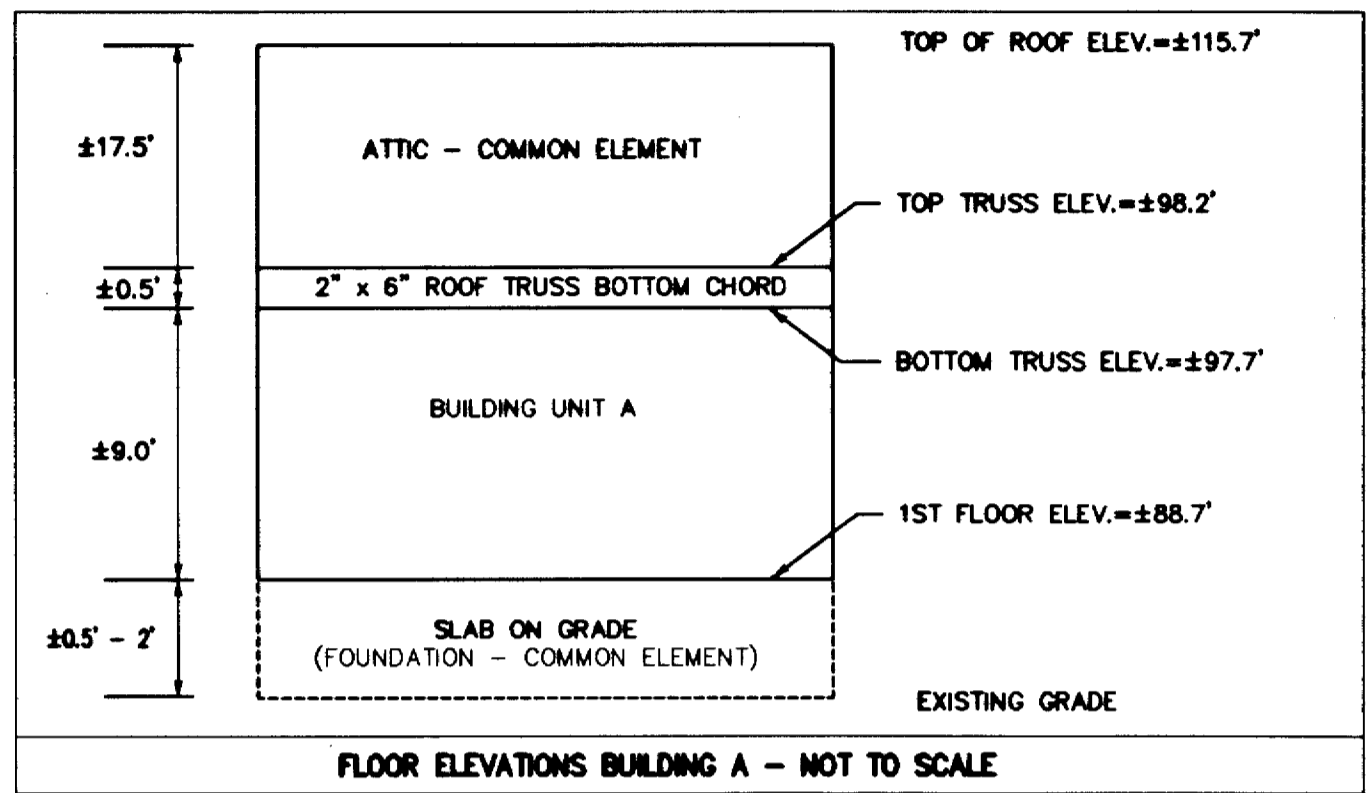

SHEET 2 OF 2

LandTech Resources, Inc.
 Surveying • Mapping • GPS
 5810-F Mooretown Road, Williamsburg, Virginia 23188
 Telephone: 757-565-1677 Fax: 757-565-0782
 Web: landtechresources.com

PLAT SHOWING
McLaws Park Phase 2 - McLaws Center Condominiums
 Roberts District, James City County, Virginia
 PROJECT #03-616 DATE: 11-17-2003

SURVEYOR'S CERTIFICATE

I CERTIFY THAT THIS PLAT IS ACCURATE AND COMPLIES WITH THE PROVISIONS OF SECTION 55-79.58(A) AND (B) OF THE CODE OF VIRGINIA 1950 AS AMENDED AND THAT ALL UNITS DEPICTED HEREON HAVE BEEN SUBSTANTIALLY COMPLETED.

Matthew H. Connolly
 STATE CERTIFIED LAND SURVEYOR

1-23-2004
 DATE

City of Williamsburg & County of James City
 Circuit Court: This PLAT was recorded on
4 May 2004
 at 3:42 AM/PM. pgs - 2
 DOCUMENT # 040012081
 BETSY B. WOOLRIDGE, CLERK
Betsy B. Woolridge Clerk

