

#032551

EXHIBIT B-20
 SUPPLEMENTAL CONDOMINIUM PLAN
 OF
 WYNDHAM PLANTATION
 CONDOMINIUM

WILLIAMSBURG, VIRGINIA
 SCALE: 1"=10' OCTOBER 28, 2003
 JOHN E. SIRINE AND ASSOCIATES, LTD.
 SURVEYORS • ENGINEERS • PLANNERS
 VIRGINIA BEACH, VIRGINIA
 (757) 486-4910

NOTES:

1. BUILDING DIMENSIONS SHOWN HEREON ARE INTERIOR DIMENSIONS. THESE DIMENSIONS ARE IN FEET AND WERE TAKEN FROM PLANS SUPPLIED ENTITLED "WYNDHAM PLANTATION AT WILLIAMSBURG, FLOOR PLANS" BY PROGRESSIVE DESIGNS DATED 11/19/98.
2. INTERIOR UNIT CONFIGURATIONS AND PARTITIONS AS DEPICTED HEREON ARE FOR THE PURPOSE OF ILLUSTRATION ONLY AND MAY NOT REPRESENT THE INTERIOR OF A UNIT AS ACTUALLY CONSTRUCTED.

SECOND FLOOR - BUILDING 32
 SCALE: 1"=10'

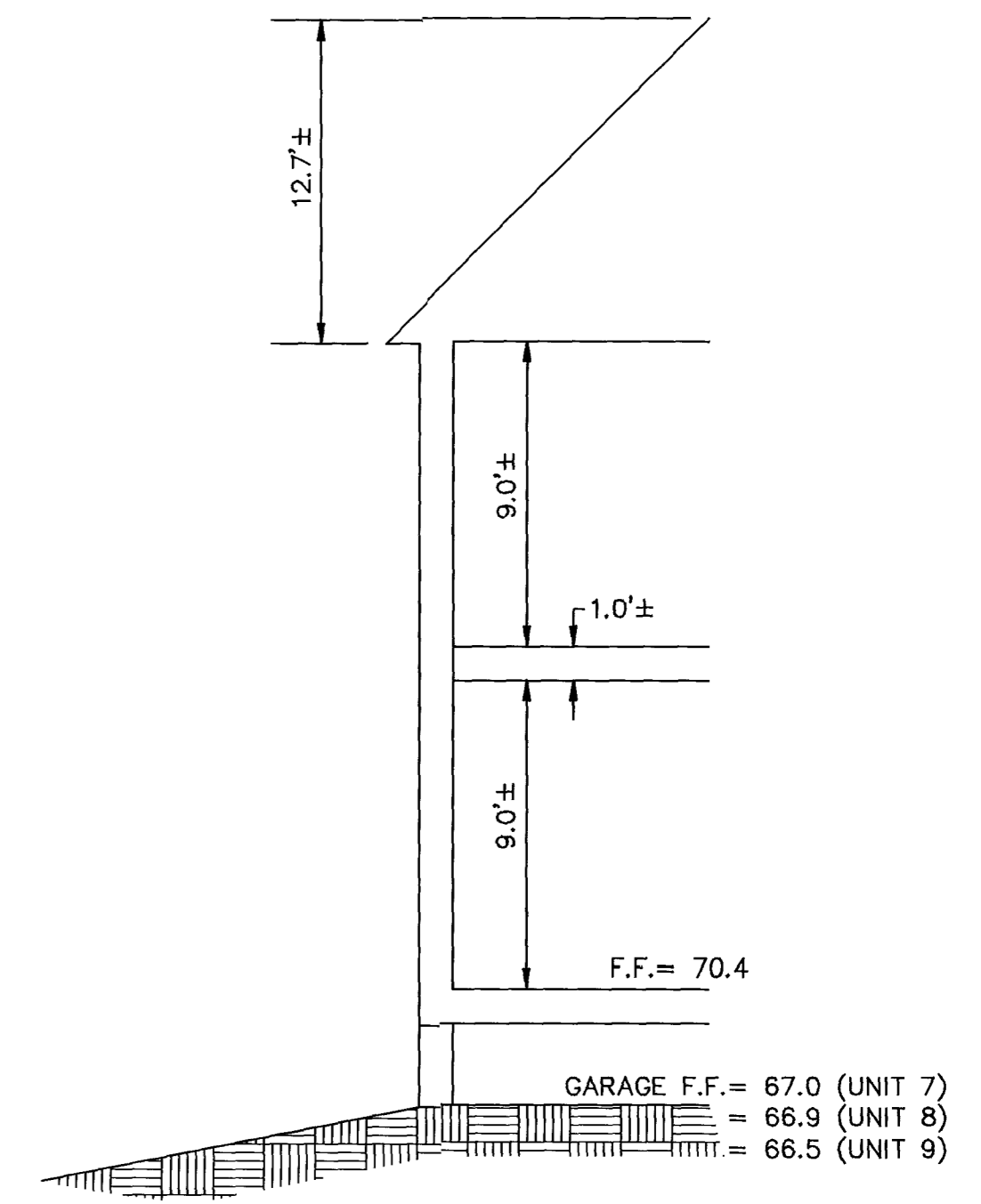
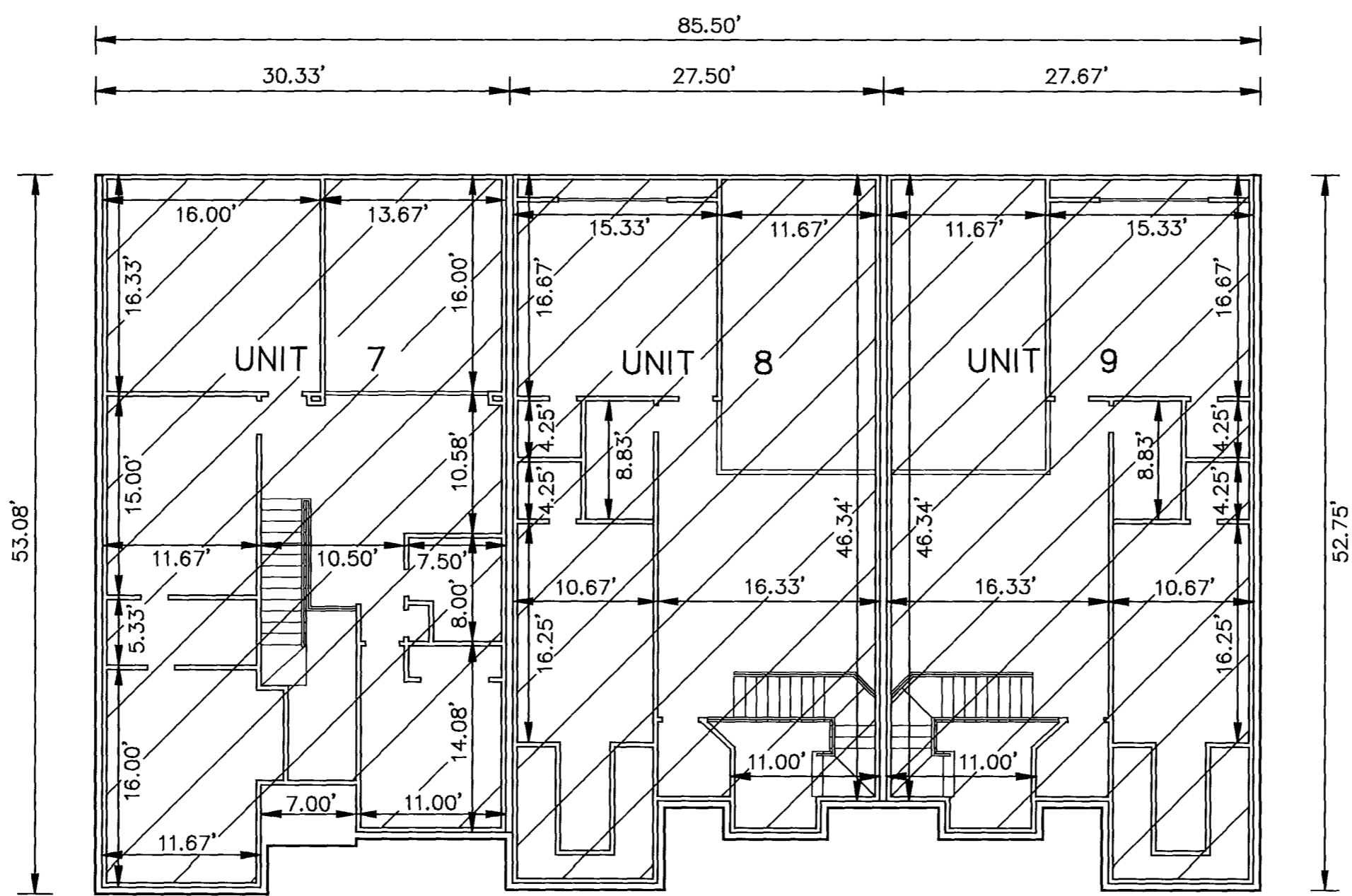

SCALE: 1"=5'

UNIT AREA

| PHASE | UNIT No. | UNIT ADDRESS | UNIT AREA |
|-------|----------|------------------|------------|
| 22 | 7 | 201 ZELKOVA ROAD | 1,853 S.F. |
| 22 | 8 | 205 ZELKOVA ROAD | 1,800 S.F. |
| 22 | 9 | 209 ZELKOVA ROAD | 1,800 S.F. |

THE UNDERSIGNED CERTIFIES THAT THESE PLANS ARE ACCURATE AND COMPLY WITH THE PROVISIONS OF CODE OF VIRGINIA, SECTION 55-79.58.B AND THAT ALL UNITS OR PORTIONS THEREOF DEPICTED HEREON AND ALL COMMON ELEMENTS HAVE BEEN SUBSTANTIALLY COMPLETED.

City of Williamsburg & County of James City
 Circuit Court: This PLAT was recorded on
 at 3:04 PM, PB 11-01-2003 PG
 DOCUMENT # 032551
 BETSY B. WOOLRIDGE, CLERK
Betsy B. Woolridge Clerk

SIGNED: *Jeffrey D. Williams*
 JEFFREY D. WILLIAMS, L.S.

