

#032293

EXHIBIT B-19  
 SUPPLEMENTAL CONDOMINIUM PLAN  
 OF  
 WYNDHAM PLANTATION  
 CONDOMINIUM

WILLIAMSBURG, VIRGINIA  
 SCALE: 1"=10' SEPTEMBER 3, 2003  
 JOHN E. SIRINE AND ASSOCIATES, LTD.  
 SURVEYORS • ENGINEERS • PLANNERS  
 VIRGINIA BEACH, VIRGINIA  
 (757) 486-4910

NOTES:

1. BUILDING DIMENSIONS SHOWN HEREON ARE INTERIOR DIMENSIONS. THESE DIMENSIONS ARE IN FEET AND WERE TAKEN FROM PLANS SUPPLIED ENTITLED "WYNDHAM PLANTATION AT WILLIAMSBURG, FLOOR PLANS" BY PROGRESSIVE DESIGNS DATED 11/19/98.
2. INTERIOR UNIT CONFIGURATIONS AND PARTITIONS AS DEPICTED HEREON ARE FOR THE PURPOSE OF ILLUSTRATION ONLY AND MAY NOT REPRESENT THE INTERIOR OF A UNIT AS ACTUALLY CONSTRUCTED.

SECOND FLOOR - BUILDING 4

SCALE: 1"=10'

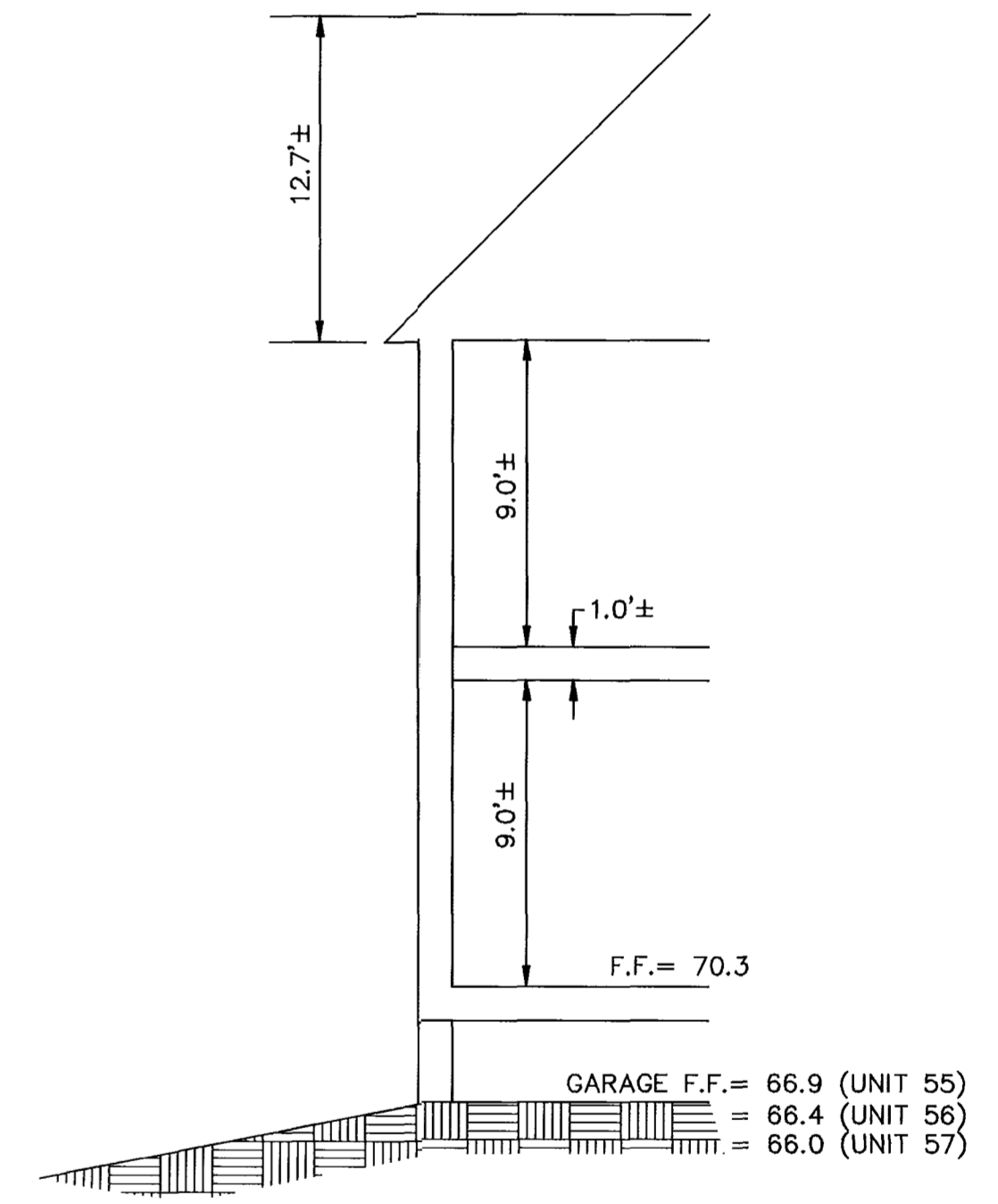
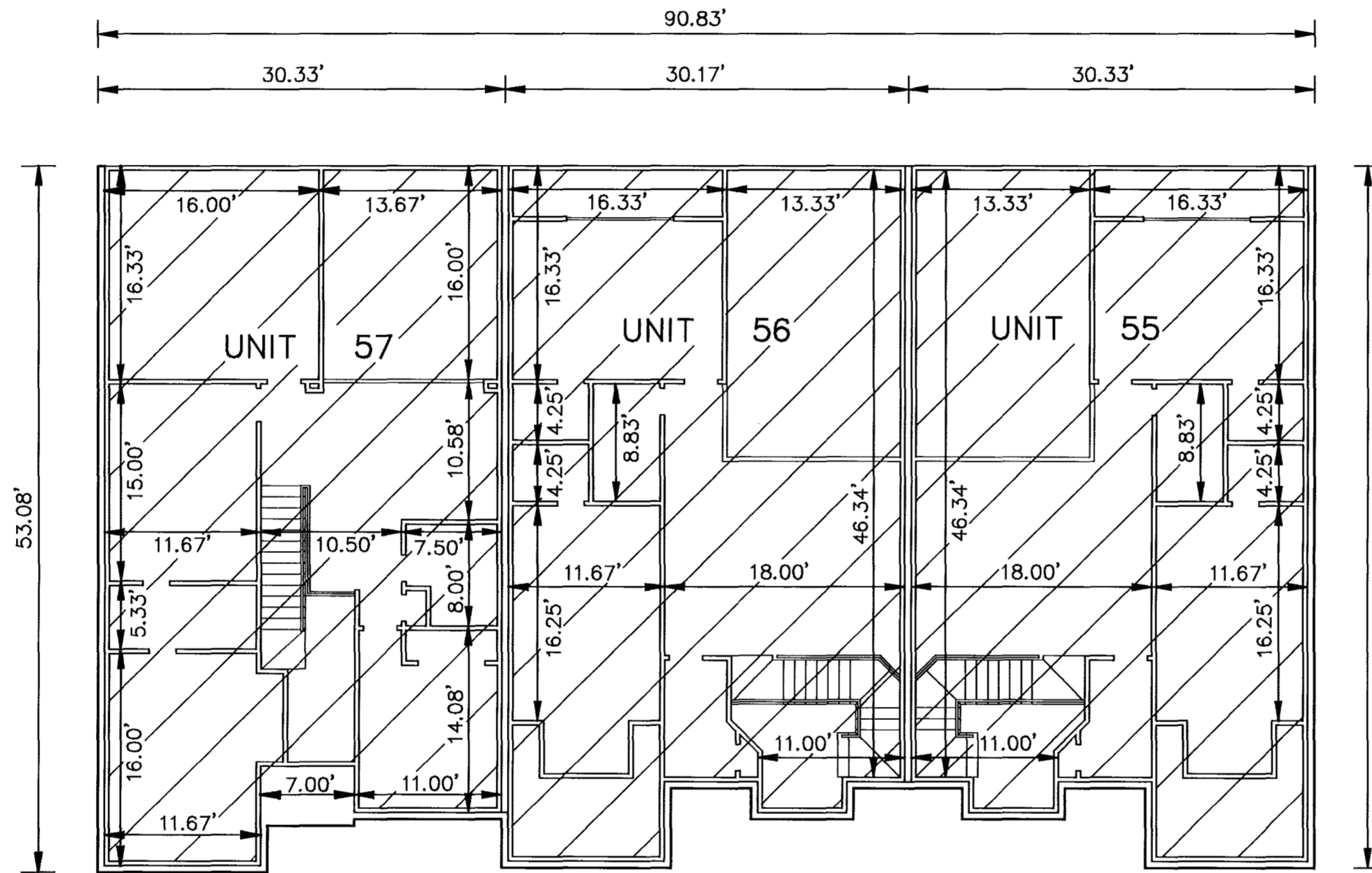

SCALE: 1"=5'

UNIT AREA

PHASE	UNIT No.	UNIT ADDRESS	UNIT AREA
21	55	200 ZELKOVA ROAD	2,101 S.F.
21	56	204 ZELKOVA ROAD	1,957 S.F.
21	57	208 ZELKOVA ROAD	1,853 S.F.

THE UNDERSIGNED CERTIFIES THAT THESE PLANS ARE ACCURATE AND COMPLY WITH THE PROVISIONS OF CODE OF VIRGINIA, SECTION 55-79.58.B AND THAT ALL UNITS OR PORTIONS THEREOF DEPICTED HEREON AND ALL COMMON ELEMENTS HAVE BEEN SUBSTANTIALLY COMPLETED.

City of Williamsburg & County of James City  
 Circuit Court: This PLAT was recorded on  
 9 October 2003  
 at 10:36 AM/PM, PG. 1  
 DOCUMENT # 032293  
 BETSY B. WOOLRIDGE, CLERK  
 Betsy B. Woolridge Clerk

SIGNED: JEFFREY D. WILLIAMS  
 JEFFREY D. WILLIAMS, L.S.

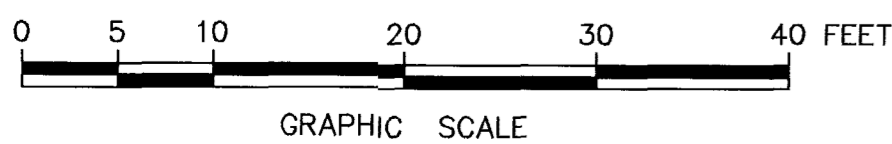
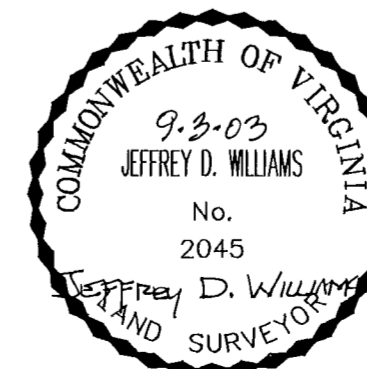

GRAPHIC SCALE