

OWNER'S CERTIFICATE

THE SUBDIVISION OF LAND SHOWN ON THIS PLAT AND KNOWN AS FORD'S COLONY AT WILLIAMSBURG, SECTION XXXII, IS WITH FREE CONSENT AND IN ACCORDANCE WITH THE DESIRES OF THE UNDERSIGNED OWNERS, PROPRIETORS, AND/OR TRUSTEES.

*Drew R. Mulhare*  
FOR REALTEC, INCORPORATED  
DATE August 21, 2001

*DREW R. MULHARE*  
PRINTED NAME

CERTIFICATE OF NOTARIZATION

STATE OF VIRGINIA, CITY/COUNTY OF *James City*  
TO WIT: I, *Pamela Dawn Callis*  
A NOTARY PUBLIC IN AND FOR THE CITY/COUNTY AND STATE AFORESAID, DO HEREBY CERTIFY THAT THE PERSONS WHOSE NAMES ARE SIGNED TO THE FOREGOING WRITING HAVE ACKNOWLEDGED THE SAME BEFORE ME IN THE CITY/COUNTY AFORESAID. GIVEN UNDER MY HAND THIS *21* DAY OF *August*, 2001.  
MY COMMISSION EXPIRES *6/3/02*  
*Pamela Dawn Callis*  
SIGNATURE

CERTIFICATION OF SOURCE OF TITLE

THE LAND EMBRACED IN THIS SUBDIVISION IS IN THE NAME OF REALTEC INCORPORATED, AND WAS ACQUIRED FROM ELIZABETH CARTER BY INSTRUMENT #990001247, DATED JANUARY 20, 1999 AND DULY RECORDED IN THE CLERK'S OFFICE OF THE CIRCUIT COURT OF JAMES CITY COUNTY AND BY BOUNDARY LINE AGREEMENT WITH WARHILL CORPORATION BY INSTRUMENT #990021241.

ENGINEER OR SURVEYOR'S CERTIFICATE

I HEREBY CERTIFY THAT TO THE BEST OF MY KNOWLEDGE AND BELIEF, THIS PLAT COMPLIES WITH ALL OF THE REQUIREMENTS OF THE BOARD OF SUPERVISORS AND ORDINANCES OF THE COUNTY OF JAMES CITY, VIRGINIA, REGARDING THE PLATTING OF SUBDIVISIONS WITHIN THE COUNTY.  
*G. T. Wilson, Jr.*  
G. T. WILSON, JR. C.L.S.  
DATE 6/22/01

CERTIFICATE OF APPROVAL

THIS SUBDIVISION IS APPROVED BY THE UNDERSIGNED IN ACCORDANCE WITH EXISTING SUBDIVISION REGULATIONS AND MAY BE ADMITTED TO RECORD.  
*[Signature]*  
SUBDIVISION AGENT OF JAMES CITY COUNTY  
DATE 4/22/03

STATE OF VIRGINIA  
COUNTY OF JAMES CITY

IN THE CLERK'S OFFICE OF THE CIRCUIT COURT OF THE COUNTY OF JAMES CITY, THIS 9 DAY OF June, 2003. THE MAP SHOWN HEREON WAS PRESENTED AND ADMITTED TO THE RECORD AS THE LAW DIRECTS.

TESTE: *Betsy B. Woolridge* By *Claudia A. Berkholz*  
CLERK

PLAT BOOK 90, PAGE 48-52

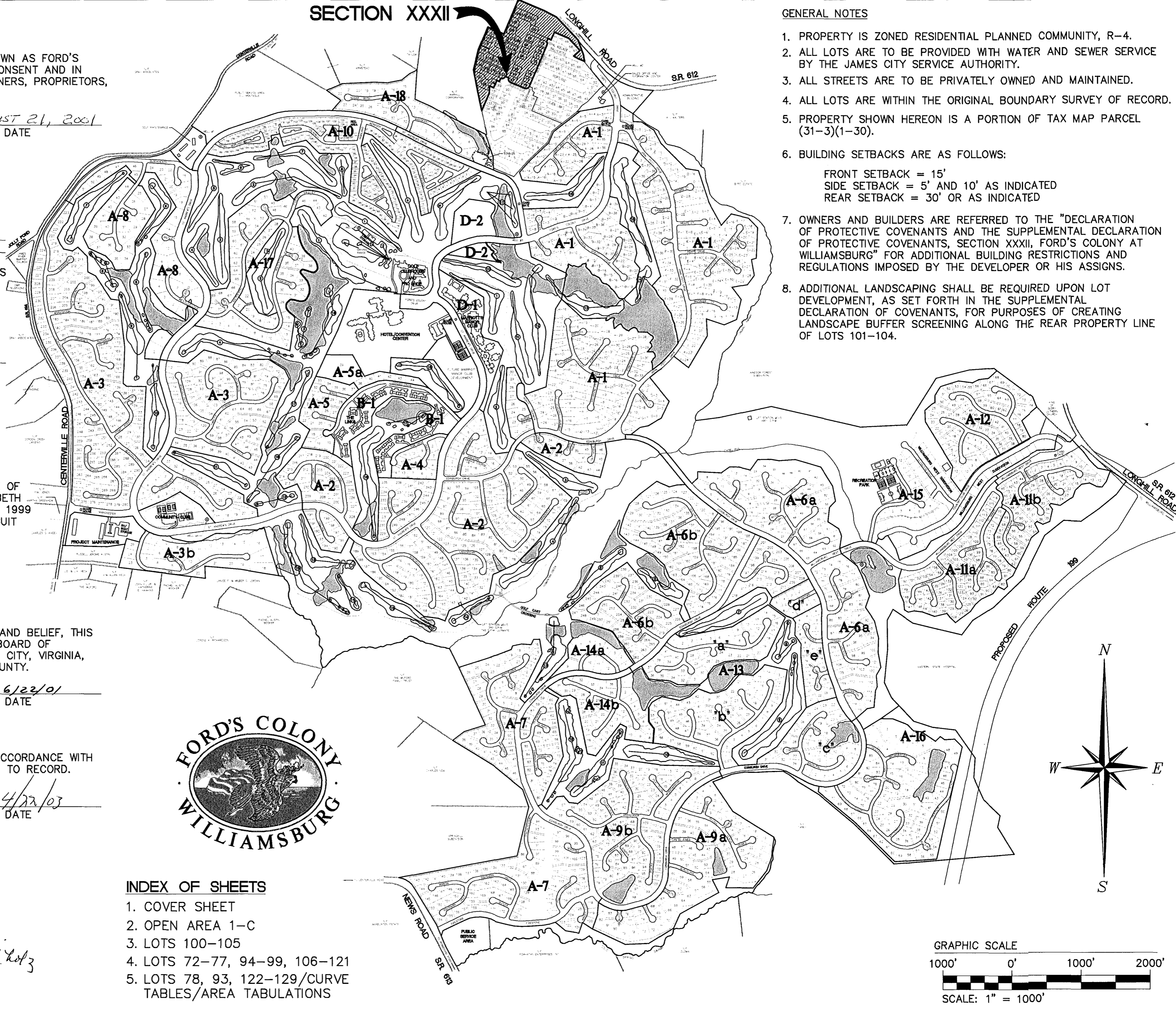

GENERAL NOTES

1. PROPERTY IS ZONED RESIDENTIAL PLANNED COMMUNITY, R-4.
2. ALL LOTS ARE TO BE PROVIDED WITH WATER AND SEWER SERVICE BY THE JAMES CITY SERVICE AUTHORITY.
3. ALL STREETS ARE TO BE PRIVATELY OWNED AND MAINTAINED.
4. ALL LOTS ARE WITHIN THE ORIGINAL BOUNDARY SURVEY OF RECORD.
5. PROPERTY SHOWN HEREON IS A PORTION OF TAX MAP PARCEL (31-3)(1-30).
6. BUILDING SETBACKS ARE AS FOLLOWS:  
FRONT SETBACK = 15'  
SIDE SETBACK = 5' AND 10' AS INDICATED  
REAR SETBACK = 30' OR AS INDICATED
7. OWNERS AND BUILDERS ARE REFERRED TO THE "DECLARATION OF PROTECTIVE COVENANTS AND THE SUPPLEMENTAL DECLARATION OF PROTECTIVE COVENANTS, SECTION XXXII, FORD'S COLONY AT WILLIAMSBURG" FOR ADDITIONAL BUILDING RESTRICTIONS AND REGULATIONS IMPOSED BY THE DEVELOPER OR HIS ASSIGNS.
8. ADDITIONAL LANDSCAPING SHALL BE REQUIRED UPON LOT DEVELOPMENT, AS SET FORTH IN THE SUPPLEMENTAL DECLARATION OF COVENANTS, FOR PURPOSES OF CREATING LANDSCAPE BUFFER SCREENING ALONG THE REAR PROPERTY LINE OF LOTS 101-104.

INDEX OF SHEETS

1. COVER SHEET
2. OPEN AREA 1-C
3. LOTS 100-105
4. LOTS 72-77, 94-99, 106-121
5. LOTS 78, 93, 122-129/CURVE TABLES/AREA TABULATIONS

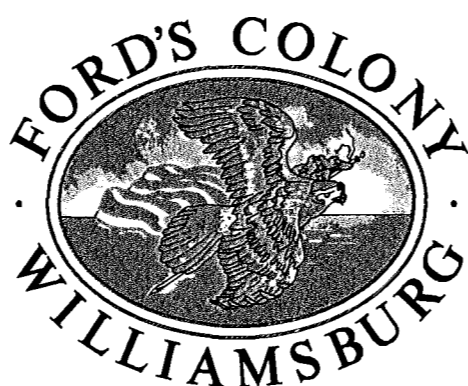

90 PAGE 48 #030017011

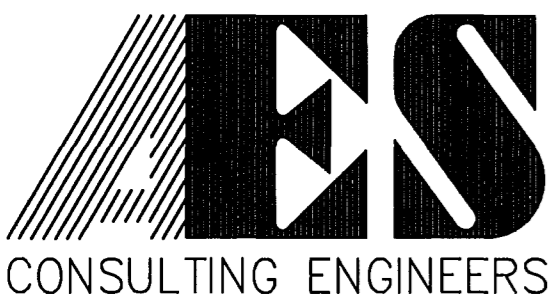

5248 Olde Towne Road, Suite 1  
Williamsburg, Virginia 23188  
(757) 253-0040  
Fax (757) 220-8994

PLAT OF SUBDIVISION  
SECTION XXXII  
LOTS 72 - 78, 93 - 129  
**FORD'S COLONY  
AT WILLIAMSBURG**

POWhatan DISTRICT      JAMES CITY COUNTY      VIRGINIA



City of Williamsburg & County of James City		
Circuit Court: This PLAT was recorded on		
at <i>9 June 2003</i>		
at <i>1:08</i> AM/PM, PB <i>90</i> PG <i>48-52</i>		
DOCUMENT # <i>030017011</i>		
BETSY B. WOOLRIDGE, CLERK		
<i>Betsy B. Woolridge</i> Clerk		
No.	DATE	REVISION / COMMENT / NOTE

Designed CBR	Drawn AES
Scale 1"=1000'	Date 6/22/01
Project No. 5652-32C	
Drawing No. 1 OF 5	