

#021288

86 PAGE 97

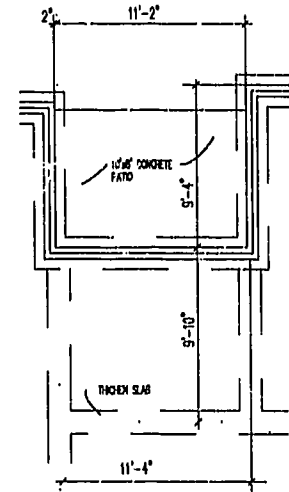
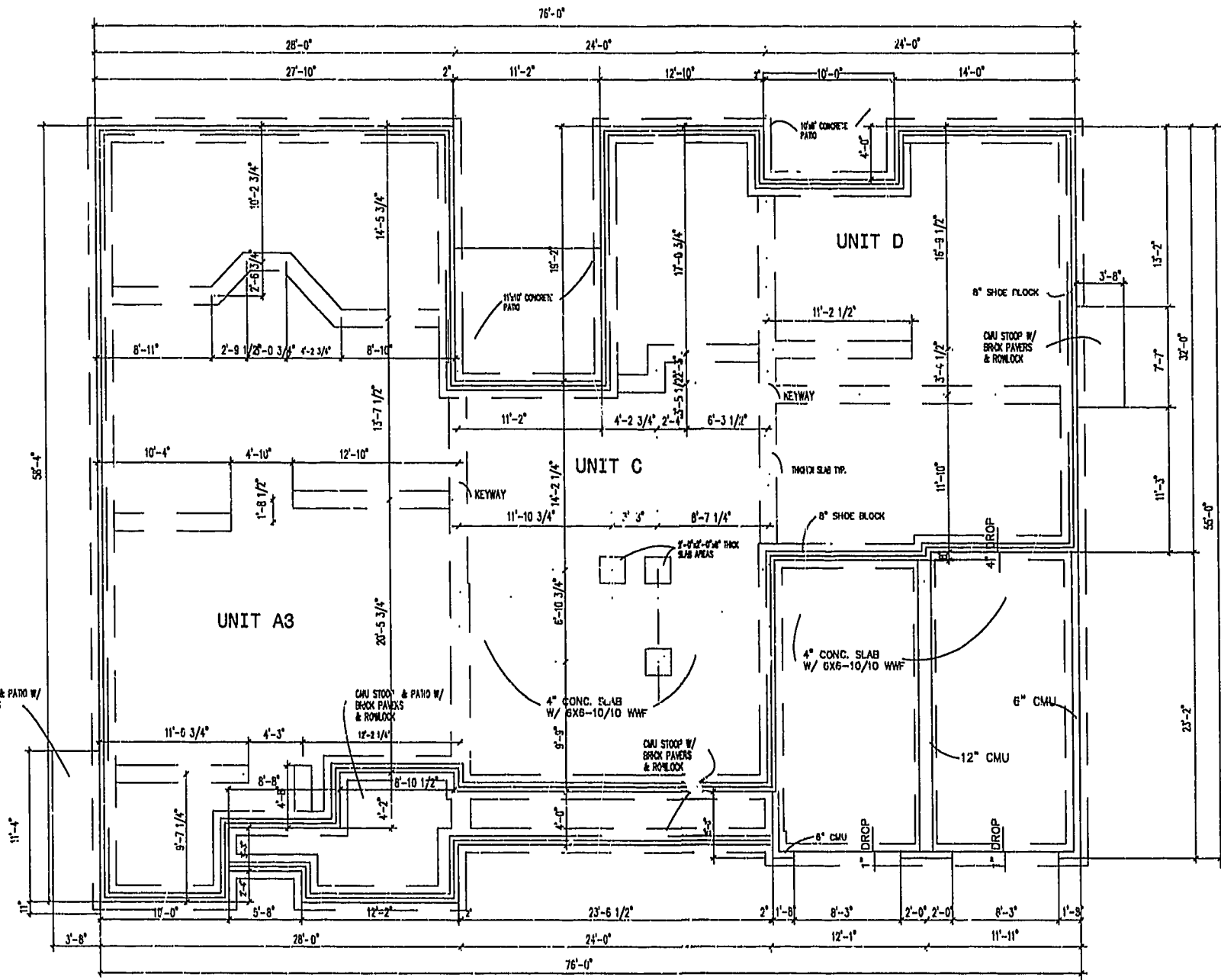

FOUNDATION PLAN  
NOT TO SCALE

City of Williamsburg & County of James City  
 Circuit Court: This PLAT was recorded on  
 22 July 2002  
 at 10:27 AM/PM: PG 86, PG 88-10  
 DOCUMENT # 021288  
 BETSY B. WOOLRIDGE, CLERK  
 Betsy B. Woolridge, Dep. Clerk



NOTE: ARCHITECTURAL PLANS PREPARED BY BEN ADDERHOLDT - ARCHITECT.

EXHIBIT "A"  
 CLAIBORNE  
 (A CONDOMINIUM COMMUNITY)  
 PHASE TWO

|  |         |                      |                   |                            |               |
|--|---------|----------------------|-------------------|----------------------------|---------------|
| Hassell & Folkes, P.C.<br>Engineers Surveyors Planners<br>Chesapeake, VA 23320<br>(757) 547-9531 | SIZE: C | CONTRACT NO: 114C/16 | DISK/BOX: 114C/16 | FILENAME: PH-2-BLDG-13.DWG | REV.          |
| CITY OF WILLIAMSBURG, VIRGINIA   |         |                      | SCALE: AS SHOWN   | DATE: 07/10/02             | SHEET 8 of 12 |

A-1520

A-1520