

BUILDING NUMBER	UNIT NUMBER	STREET ADDRESS
22	2201	2201 WESTGATE CIRCLE
22	2202	2202 WESTGATE CIRCLE
22	2203	2203 WESTGATE CIRCLE
22	2204	2204 WESTGATE CIRCLE

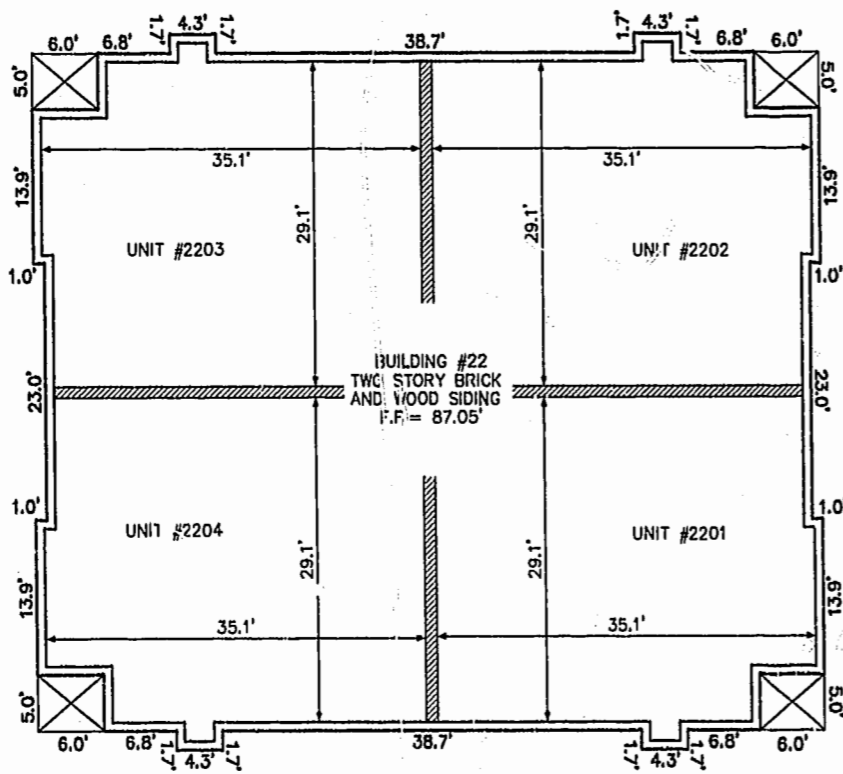

FRONT OF BUILDING  
FIRST FLOOR

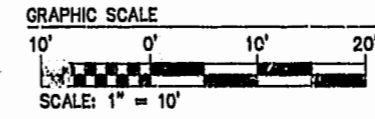
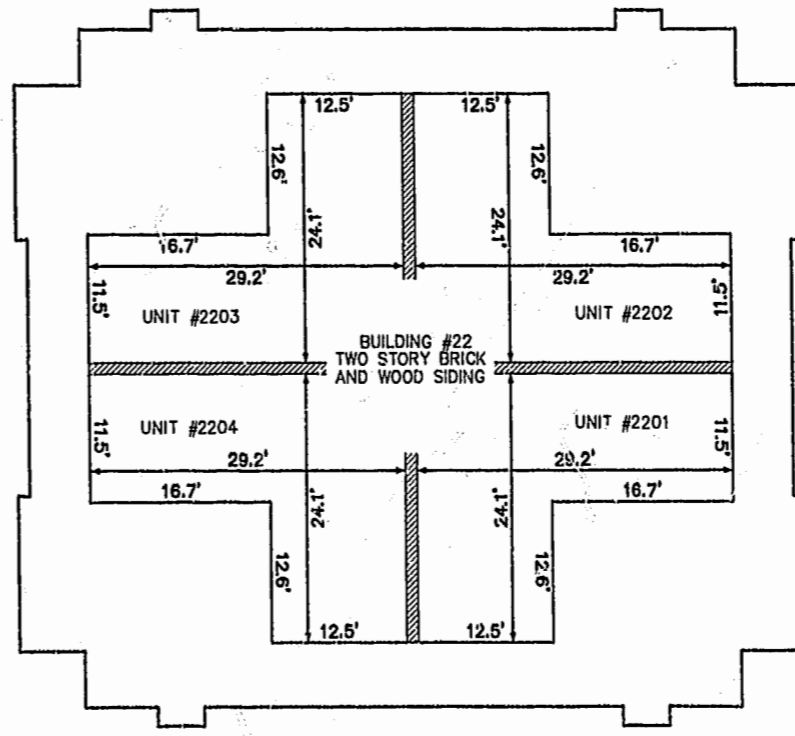

FRONT OF BUILDING  
SECOND FLOOR

11\_30\_01-09:12 8395p224.dwg JFS

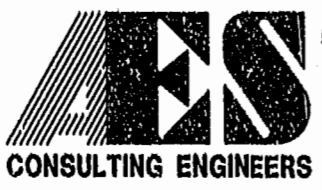

5248 Old Towne Road, Suite 1  
Williamsburg, Virginia 23188  
(757) 253-0040  
Fax (757) 220-8994

**PLAT OF CONDOMINIUM  
WESTGATE AT WILLIAMSBURG,  
A CONDOMINIUM  
PHASE TWENTY-TWO**  
OWNED BY: 752 L.L.C.,  
A VIRGINIA LIMITED LIABILITY COMPANY  
CITY OF WILLIAMSBURG VIRGINIA



No.	DATE	REVISION / COMMENT / NOTE	BY

City of Williamsburg & County of James City  
Circuit Court - This PLAT was recorded on  
10 Apr 2002  
at 2:46 PM, PG 84 PG 85 80  
DOCUMENT # 020063  
BETSY B. WOOLRIDGE, CLERK  
*Betsy Woolridge*, Dep. Clerk

Designed GTW/ADS	Drawn JFS
Scale 1" = 10'	Date 11/26/01
Project No. 8395-6	
Drawing No. 4 OF 6	