

PLAT OF RIGHT-OF-WAY ACQUISITION

TO BE CONVEYED FROM:  
EUGENE ELLSWORTH RIDDICK  
TO  
JAMES CITY COUNTY  
CONTAINING  
0.02 ACRES

LOCATED: ROBERTS MAGISTERIAL DISTRICT, JAMES CITY COUNTY, VIRGINIA  
DATE: FEBRUARY 9, 2000 SCALE: 1" = 40'  
REVISED DATE: JUNE 12, 2001

MITCHELL--WILSON ASSOCIATES, P.C.  
CIVIL ENGINEERS & LAND SURVEYORS  
720 MAIN STREET, SUITE 112  
P.O. BOX 1269  
WEST POINT, VIRGINIA 23181  
(804) 843-9744

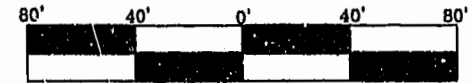

VICINITY MAP

OWNERS CERTIFICATE

THE SUBDIVISION OF LAND SHOWN ON THIS PLAT IS WITH THE FREE CONSENT AND IN ACCORDANCE WITH THE DESIRE OF THE UNDERSIGNED OWNERS, PROPRIETORS AND OR TRUSTEES.

DATE 6-22-01 Eugene Ellsworth Riddick  
EUGENE ELLSWORTH RIDDICK

CERTIFICATE OF NOTARIZATION

STATE OF ~~VIRGINIA~~ California  
CITY-COUNTY OF ~~James City~~ Los Angeles, Loretta J. Hudson A NOTARY PUBLIC IN AND FOR THE CITY-COUNTY AND STATE AFORESAID, DO HEREBY CERTIFY THAT THE PERSONS WHOSE NAMES ARE SIGNED TO THE FOREGOING WRITING HAVE ACKNOWLEDGED THE SAME BEFORE ME IN CITY-COUNTY AFORESAID, GIVEN UNDER MY NAME THIS 22 DAY OF June 2001. MY COMMISSION EXPIRES 9/17/01

SIGNATURE Loretta J. Hudson



CERTIFICATE OF SOURCE OF TITLE

THE PROPERTY SHOWN ON THIS PLAT WAS CONVEYED BY GERTRUDE REID TO EUGENE ELLSWORTH RIDDICK BY WILL DATED AND RECORDED IN THE OFFICE OF THE CLERK OF CIRCUIT COURT IN THE COUNTY OF JAMES CITY IN WILL BOOK 31 PAGE 29.

SURVEYOR'S CERTIFICATE

I HEREBY CERTIFY THAT TO THE BEST OF MY KNOWLEDGE OR BELIEF, THIS PLAT COMPLIES WITH ALL OF THE REQUIREMENTS OF THE BOARD OF SUPERVISORS AND ORDINANCES OF THE COUNTY OF JAMES CITY, VIRGINIA REGARDING THE PLATTING OF SUBDIVISION WITHIN THE COUNTY.

DATE 6-12-01 James E. Mitchell, LAND SURVEYOR

CERTIFICATE OF APPROVAL

THIS SUBDIVISION IS APPROVED BY THE UNDERSIGNED IN ACCORDANCE WITH EXISTING SUBDIVISION REGULATIONS AND MAY BE ADMITTED TO RECORD.

DATE N/A VIRGINIA DEPARTMENT OF TRANSPORTATION

DATE N/A VIRGINIA DEPARTMENT OF HEALTH

DATE 6/27/01 James E. Mitchell SUBDIVISION AGENT OF JAMES CITY COUNTY

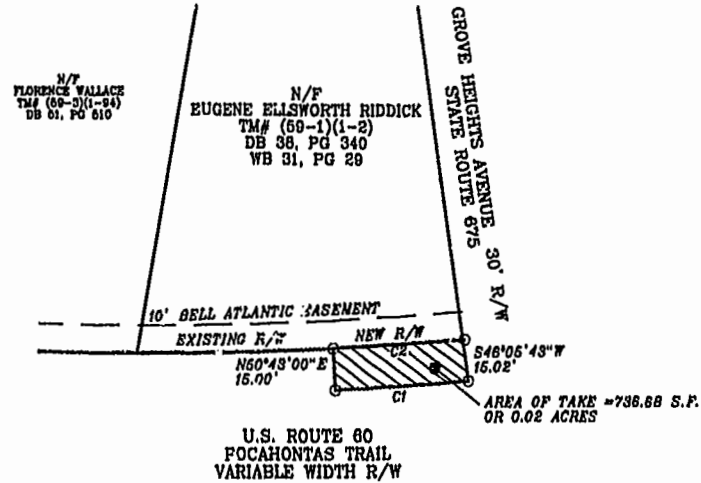

CURVE DATA:

1	DELTA	= 2°01'17"
	RADIUS	= 1409.29'
	LENGTH	= 49.72'
	TAN.	= 24.08'
	CHORD	= 49.72'
	CB	= N40°17'38"W
1	DELTA	= 1°59'36"
	RADIUS	= 1394.29'
	LENGTH	= 48.51'
	TAN.	= 24.26'
	CHORD	= 48.50'
	CB	= S40°16'48"E

City of Williamsburg & County of James City  
Circuit Court: This PLAT was recorded on  
22 March 2002  
at 9:17 AM/PM 85 PG. 55  
DOCUMENT # 020007469  
BETSY B. WOOLRIDGE, CLERK  
Betsy B. Woolridge Reg. Clerk

