

NOW OR FORMERLY  
COLLEGE OF WILLIAM & MARY

IRONBOUND

(APPROX. R/W)

ROAD

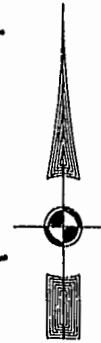

T.P. 372-(OA)-00-028  
NOW OR FORMERLY  
JEROME & EVELYN RANDOLPH  
(D.B. 30, PG. 470)  
ZONE: RM-2

T.P. 372-(OA)-00-030  
NOW OR FORMERLY  
JEROME & EVELYN RANDOLPH  
(D.B. 37, PG. 379)  
ZONE: RM-2

T.P. 372-(05)-00-001  
NOW OR FORMERLY  
CHESAPEAKE MEDIA, INC.  
(D.B. 74, PG. 121)  
(M.B. 42, PG. 25)  
ZONE: B-2 CONDITIONAL

MATCH LINE  
SEE SHEET 3

40' R/W  
ROLAND STREET

MATCH LINE  
SEE SHEET 3

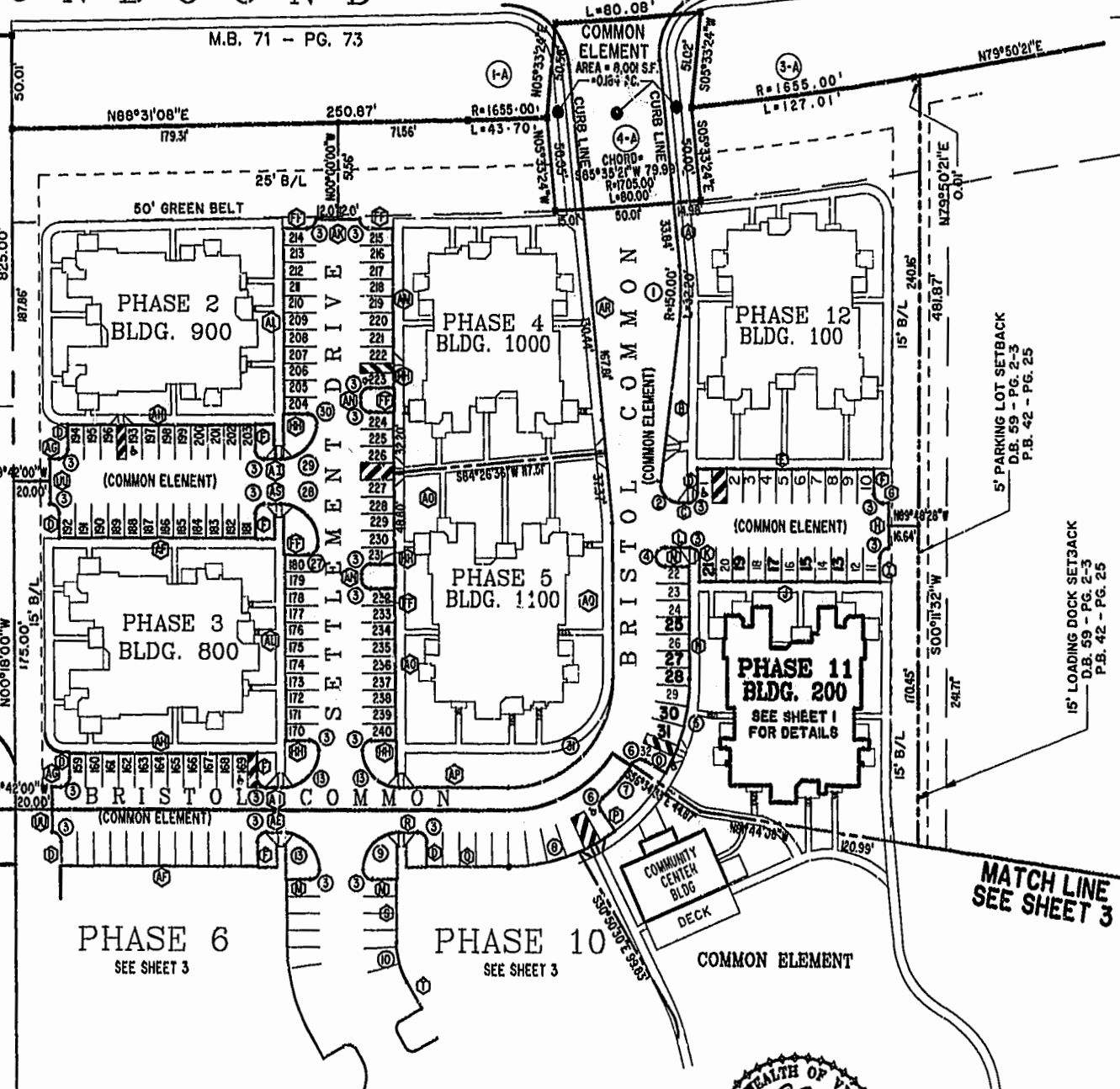

City of Williamsburg & County of James City  
Circuit Court: This PLAT was recorded on  
*November 21, 2011*  
at 10:31 AM, PG. 3 PG. 28-70  
DOCUMENT # 011807  
BETSY B. WOOLRIDGE, CLF,AK  
*Betsy Woolridge*, Dep. Clerk

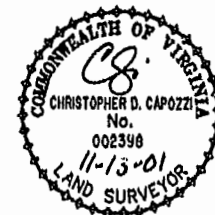

BRISTOL COMMONS  
A CONDOMINIUM COMMUNITY  
PHASE ELEVEN  
FOR  
KEY GROUP, LLC  
CITY OF WILLIAMSBURG, VIRGINIA

Hassell & Polkes, P.C. Engineers Surveyors Planners Chesapeake, VA 23320 (757) 547-9531	SIZE C	CONTRACT NO 63062	DISK/BOX 123M/15	FILENAME BRISTOL.DWG	REV. 1
SCALE: 1"=50'		DATE: 11/05/01		SHEET 2 of 4	